

Windows, French doors, outward opening, SFB 1074 **removal of smoke and evacuation of persons**

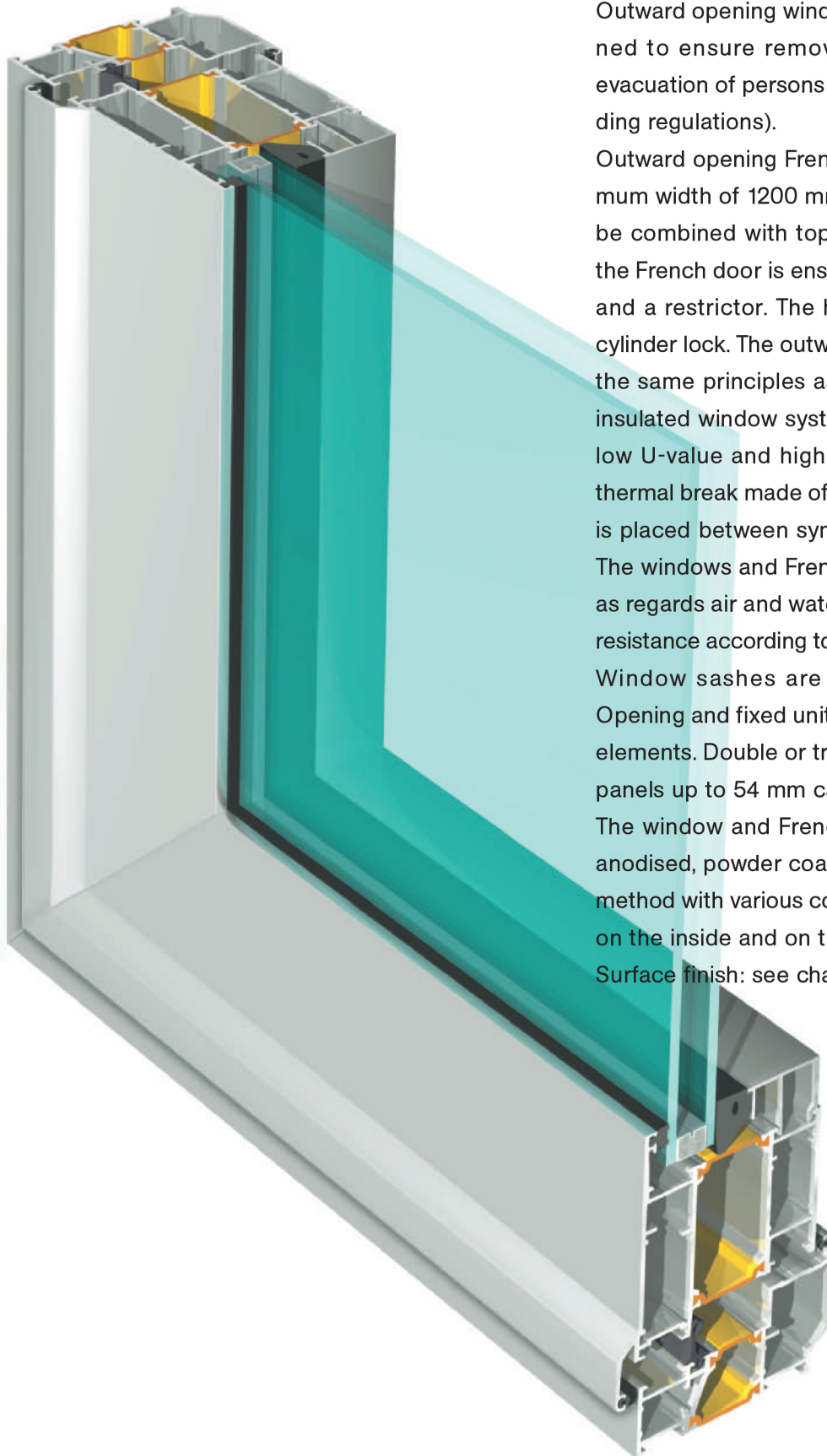

Outward opening windows SFB 1074 have been designed to ensure removal of smoke and appropriate evacuation of persons in the case of fire (National building regulations).

Outward opening French doors SFB 1074 with a maximum width of 1200 mm and a height of 2400 mm can be combined with top and side elements. Locking of the French door is ensured by a 3-point casement bolt and a restrictor. The handle can be equipped with a cylinder lock. The outward opening window is based on the same principles as the other windows in our well insulated window system SFB 1074, in which we get a low U-value and high air tightness in all products. A thermal break made of glass fibre reinforced polyamide is placed between symmetric chambers and grooves. The windows and French doors fulfil the requirements as regards air and water tightness as well as wind load resistance according to SS-EN 12208, 12207 and 12210. Window sashes are available in two dimensions. Opening and fixed units can be combined into window elements. Double or triple glazing units, as well as infill panels up to 54 mm can be installed in the rebate. The window and French door system profiles can be anodised, powder coated or coated using the Decoral method with various colours and types of surface finish on the inside and on the outside.

Surface finish: see chapter M.

Principle details

SFB 1074 windows, French doors, outward opening

Different combinations of frame and sash profiles are possible in outward opening SFB 1074 windows. Functions of fittings: Sapa Building System standard outward opening windows SFB 1074 are used for single windows, windows with top light, windows with side light, or in window elements/glazed elements. The sash

profiles can be also installed in facade systems SFB 3074, 4150, 4060 and 5050 SG, see chapter D. The size of windows: max. height 2400 mm, max. width 1200 mm, min. height 1800 mm, min. width 700 mm, and max. weight of sash 130 kg.

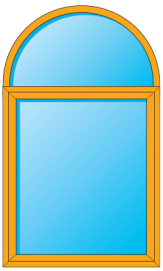

Outward opening windows, with arched top light as an alternative

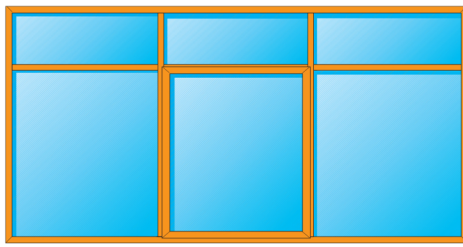

Outward opening windows with fixed side lights, or top light as an alternative



Outward opening French door

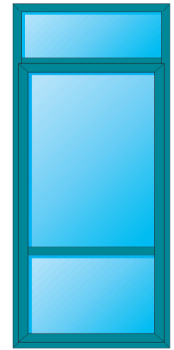

Outward opening French door with top light, or side light as an alternative

Frame/sash combinations in outward opening windows

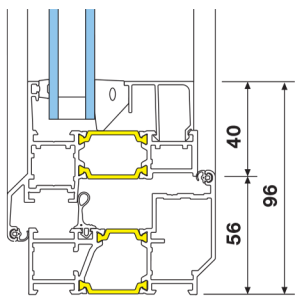

Frame with narrow sash

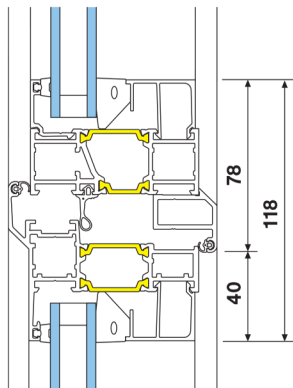

Narrow sash in fixed top/side light

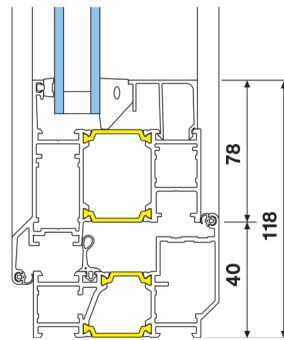

Frame with wide sash

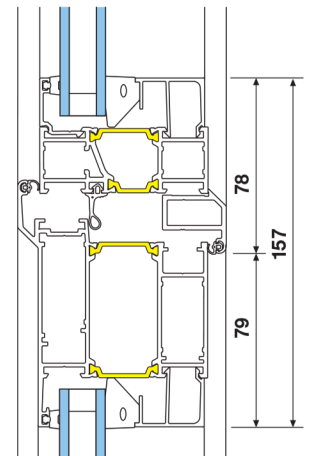

Wide sash in fixed top/side light

Infill panels in door leaves

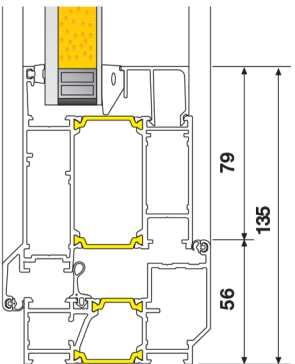

Door leaf, Vaku-Paneel infill panel, see page F-38

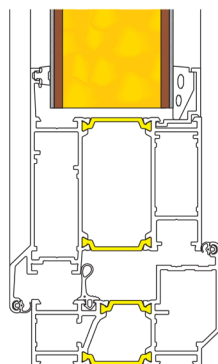

Door leaf with F1, F2, F3, F4 infill panel, see page F-38

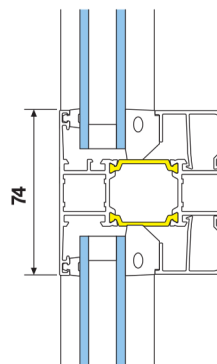

Cross-bar

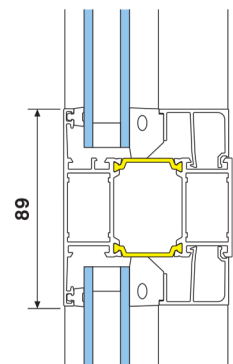

Cross-bar