

# Windows, inward opening, in light walls

## SFB 1074

The SFB 1074 window system has been extended with a frame suitable for rational installation in light wall structures, consisting of sheet plate and insulation material. The frame has a rebate against the outside wall surface and is fixed with hidden fittings from the inside. The inside is complemented with an encasement made of special aluminium profiles. SFB 1074 has a low U-value over the profile section including the glass. Double or triple glazing units, as well as infill panels up

to 54 mm can be installed in the rebate. Windows and window groups SFB 1074 fulfil the requirements as regards air and water tightness as well as wind load resistance according to SS-EN 12208, 12207 and 12210. The window system profiles can be anodised (natural and Hardoxal colours), powder coated (NCS-S and RAL) or coated using the effective Decoral method with various patterns.

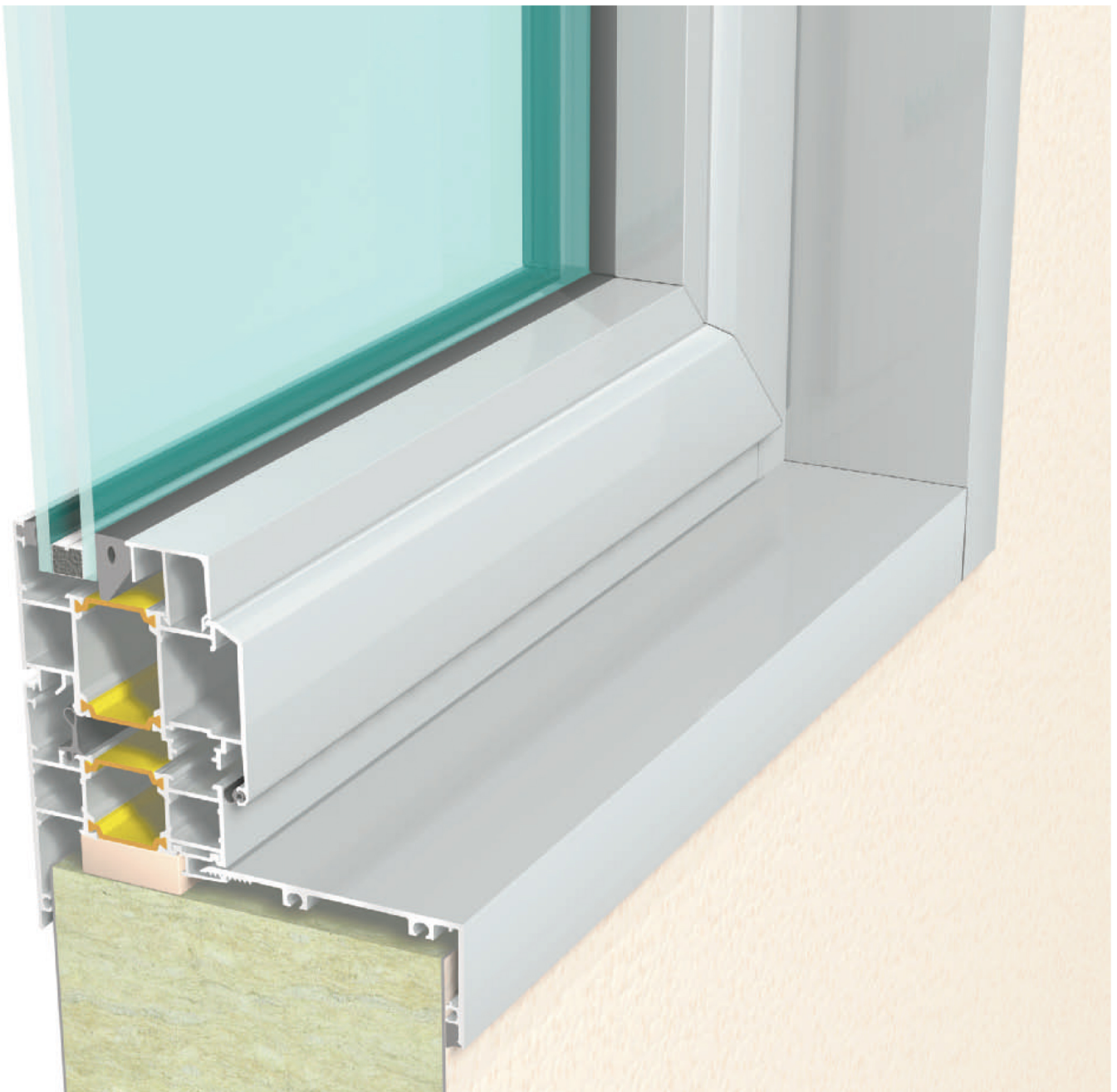

# Principle details

## SFB 1074 windows in light walls

Windows and window groups can be made as fixed or opening units, or mixed. The frame profile is always the same, while the encasement profiles used on the inside are adjusted to the wall thickness (3 different values) and the sash profile is selected according to the size, weight and function of the fittings. Inward opening windows are available in the following versions: side-hung, bottom-hung, and top-hung or with tilt-and-turn

function. SFB 1074 is used for single windows, windows with top light, windows with side light, or in window elements/glazed elements.

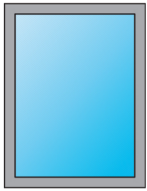

Fixed window

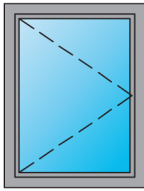

Inward opening window

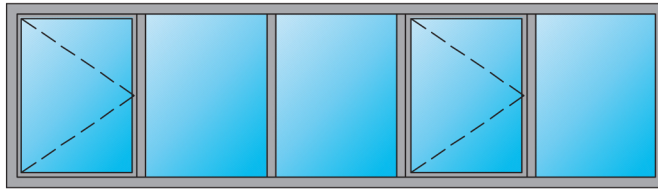

Window group, opening/fixed

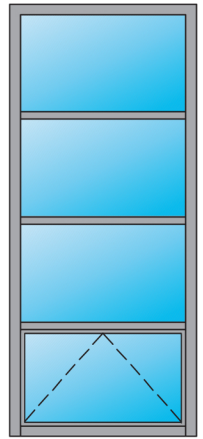

Vertical window group, opening/fixed

### Principle details

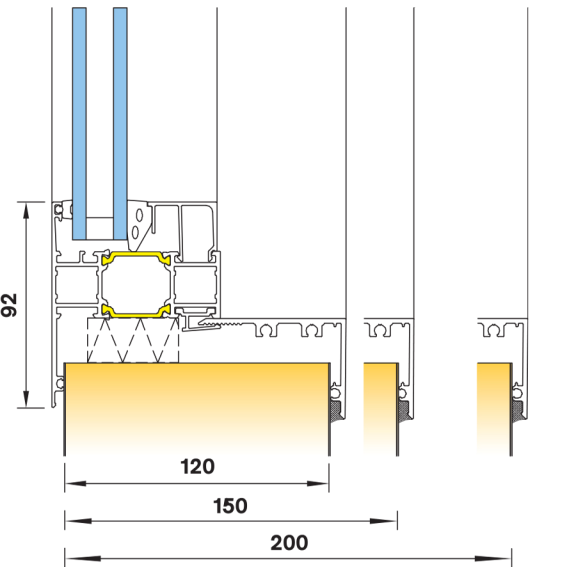

Frame with inside encasement profiles in light wall

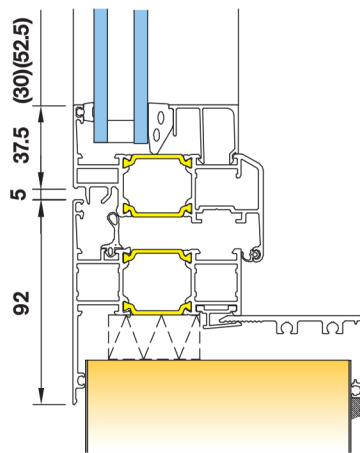

Frame with sash profile for tilt-and-turn fittings

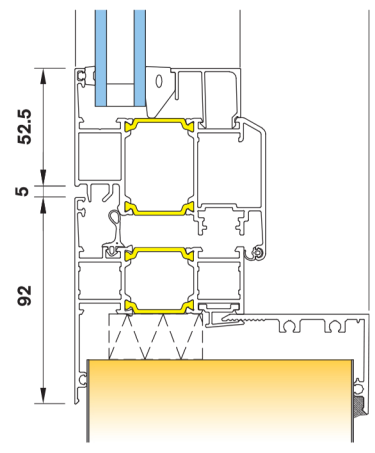

Frame with sash profile for Fix fittings

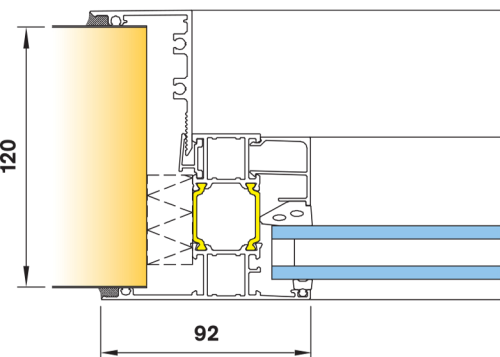

Side frame with inside encasement profiles in light wall

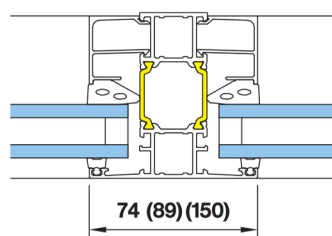

Cross-bar profile

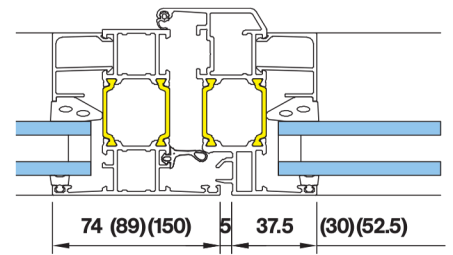

Cross-bar with sash profile