

# Facade system

## Sapa Facade 4150 SSG

Sapa 4150 SSG (Structural System Glazing) gives the facade a flat surface since the system has no external glazing profiles and is sealed with joint sealant between the glass units.

4150 SSG is built on 50 mm wide aluminium profiles and a double or triple glazing units with warm edge. The glass pane is mechanically anchored in the framework profile with mounting brackets. The glass and weather proofing become a watertight construction, so the system only requires ventilation. The internal sealing strip forms the air seal. The inner sealing strip and the construction of the thermal break optimise insulation in the profiles.

4150 SSG is an **entirely glass solution** and can be installed as a facade performed as self-supporting curtain wall, or double skin facade.

The system even comprises **openable units** that can be easily integrated.

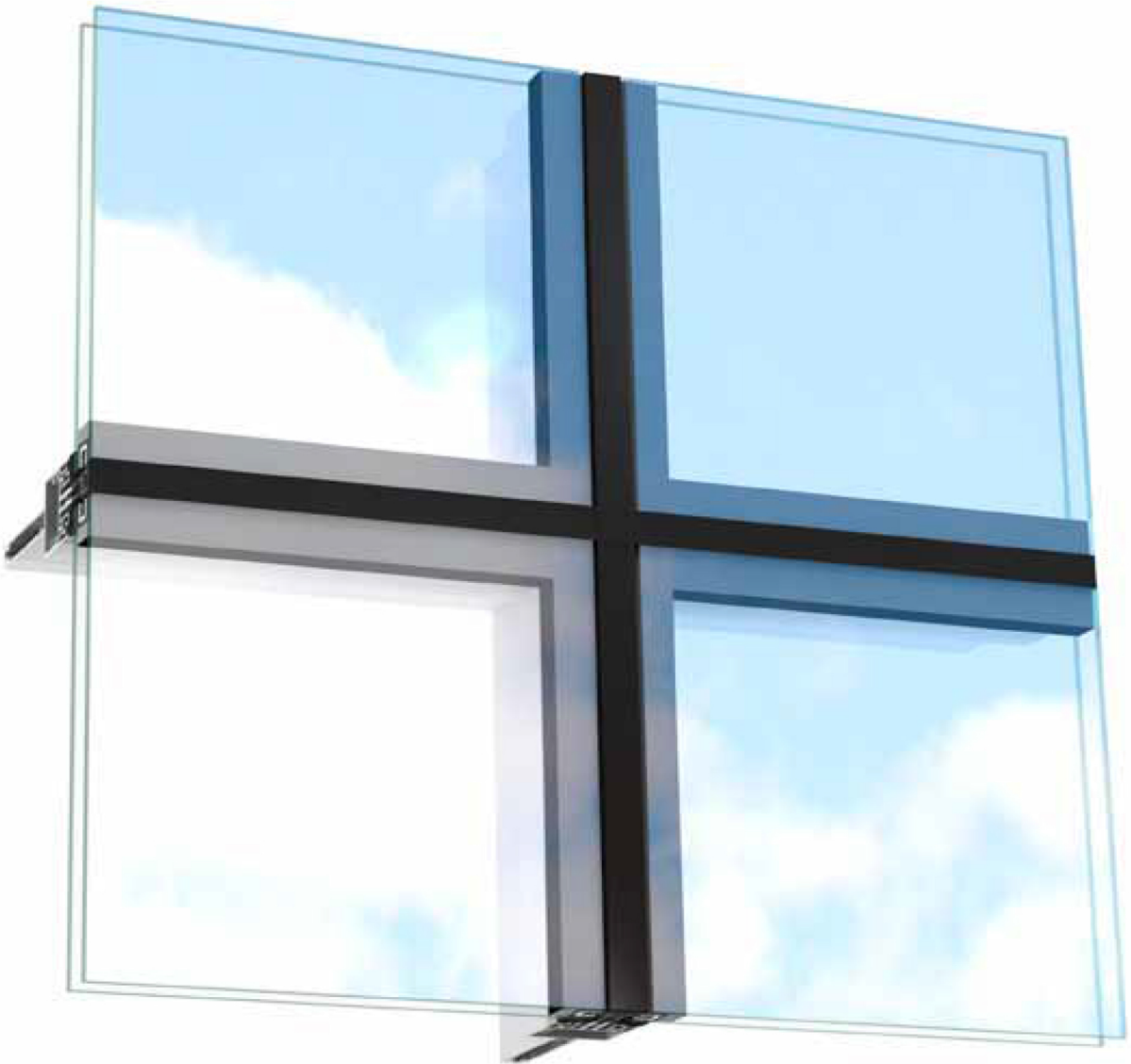

*Facade system 4150 SSG, anodised profiles.*

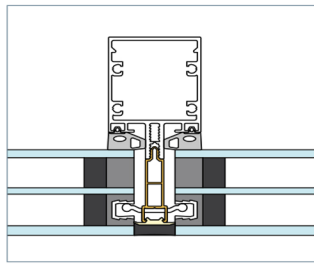
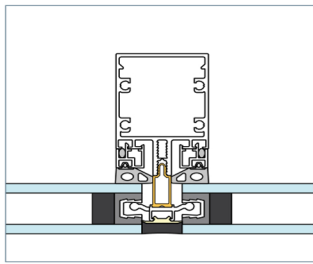

4150 SSG for double or triple glazing units.

Rebate for double or triple glazing units.  
For double glazing up to 36 mm (excl. outer glass), internal glass thickness 4-9 mm or 14-16 mm. For triple glazing up to 52 mm (excl. outer glass).  
The same profile can be used both vertically and horizontally, which gives better material usage. Glazing is always done from the outside of the construction.

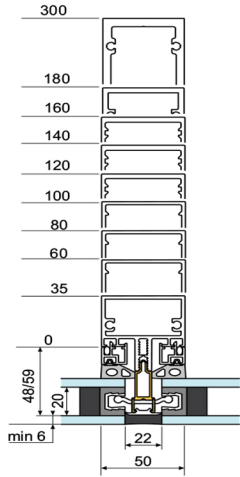

4150SSG  
with rectangular  
mullion/transom

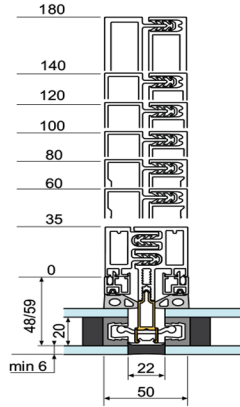

4150 SSG  
with split mullion

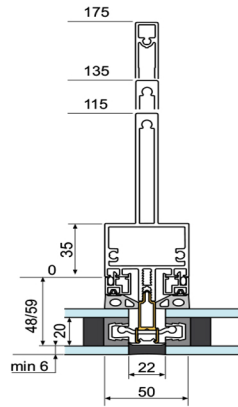

4150 SSG  
with T-shaped  
mullion/transom

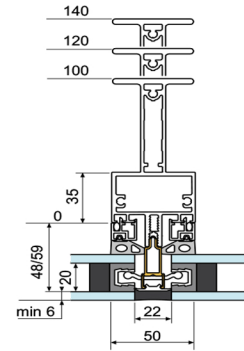

4150 SSG  
with I-shaped  
mullion



Facade system 4150 SSG at AGA factory on Lidingö, Stockholm.