

sapa:

buildingsystem

ARCHITECTURAL ALUMINIUM SOLUTIONS



## Sapa Thermo 86

Sapa Thermo 86 is our next generation of highly insulated architectural systems in aluminium for windows, doors and glazed partitions with great performance.

The system was developed in Sweden and is adapted for the harsh Nordic weather conditions and market requirements. We have taken advantage of our 40-year experience and listened carefully to our producers, manufacturers, installers as well as users and architects to produce a system that is both easy to use and with greatly improved qualities.

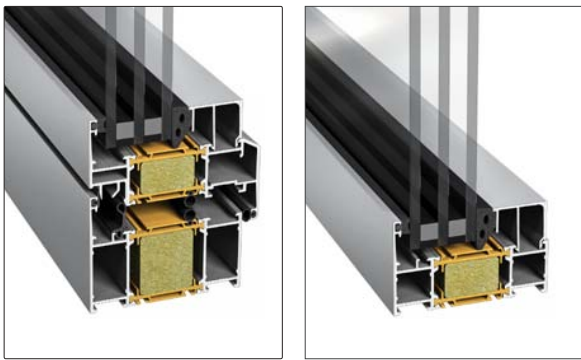

## Window 1086 Fixed window/ Partition 3086

This window is our best window. It meets the highest performance levels for air and rain tightness and offers very low U-values, down to 0.88 W/m<sup>2</sup>K for open able windows. Our aluminum window has good durability, low maintenance and long life. The windows in the Thermo 86 system can be designed as fixed, inward open able or bottom-side hung. Concealed hinges are also available. Fixed windows and glazed partitions are titled 3086.

### Fittings for bottom-side hung, inward openable



Closed position.      Airing position.      Opened position.      Closed position.  
Concealed hinges.

### Handles



Several types of handles fit our window system

### Cross sections

Below are examples of standard design.

The same configurations are also possible in the SX version, then with insulating rods in the profiles.

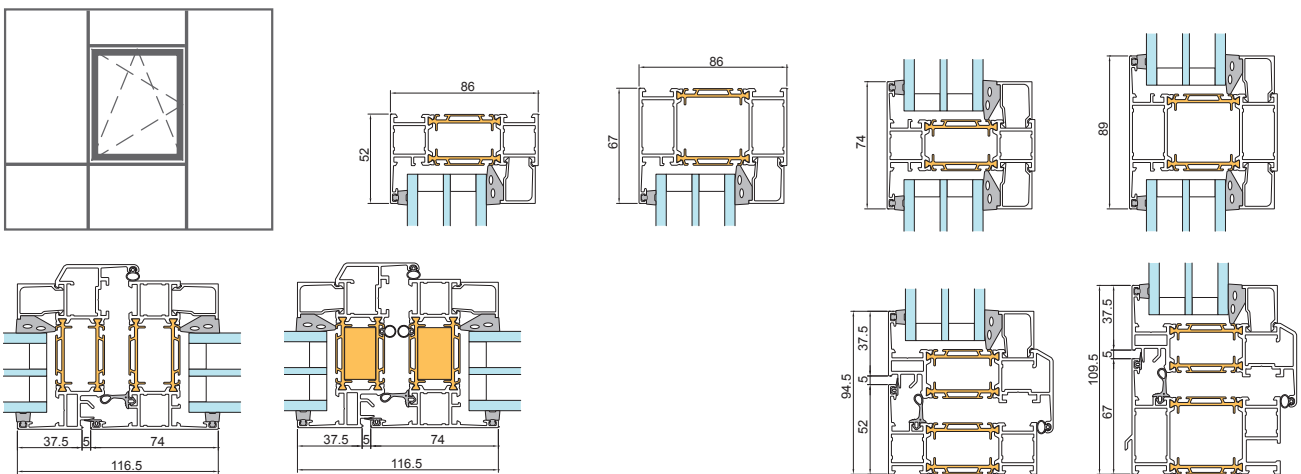

Window 1086

Window 1086 SX

	Insulating rods	Size max, mm	Size min, mm	Glass thickness	Weight kg, max	Air tightness EN 12207	Rain tightness EN 12208	Design wind load EN 12210	U <sub>w</sub> ** W/m <sup>2</sup> K	U <sub>w</sub> *** W/m <sup>2</sup> K
1086 inwards		1600x2000	550x550*	56 (64)	100 (130)	4	9A	C3	1,0	1,2
1086 SX inwards	•	1600x2000	550x550*	56 (64)	100 (130)	4	9A	C3	0,88	1,0
3086 Fixed window/partitions		beroende på belastning	n/a	56 (64)	140 (170)	4	9A	C3	0,81	0,98
3086 SX Fixed window/partitions	•	beroende på belastning	n/a	56 (64)	140 (170)	4	9A	C3	0,74	0,90

\* = 750x750 with visible hinges    \*\* U<sub>w</sub> = 0,5 W/m<sup>2</sup>K Dimension: 1230x1480 mm    \*\*\* U<sub>w</sub> = 0,7 W/m<sup>2</sup>K Dimension: 1230x1480 mm